

PROJECT NAME
RAILROAD STATION, COUNTY, STATE
SUBDIVISION MP 8.09 - MP 8.43

c:\pwordir\benesch\projects\projects\mdisper\dm49014\UPRR.tb1
c:\pwordir\benesch\projects\projects\mdisper\dm49015\UPRR_V8_Pertable.tb1
c:\pwordir\benesch\projects\projects\mdisper\d024l69\DevCon_Sample.dgn
7/10/2025

INDUSTRY NAME - FES# 12345

EXEMPTION TABLE

#	Drawing Type	Category	Standard Drawing #	Description of Exemption	Reason for Exemption	Sheet #	Track	STA
1	DEVCON	Other	0030	Use Steel Bumping Post with Shock-Free head	Track A is embedded in asphalt.	4	A	13+11.38
2	DEVCON	Turnouts	0080	Use of No. 9 POTO	Existing track geometry constraints.	3	200	19+76.00
3	DEVCON	Other	I.T.S.	Use of No RR Operations track.	Existing building creates a close clearance condition. No UP operations required per operating plan.	3, 4	D	1+47.01
4								
5								
6								
7								
8								
9								
10								
11								
12								
13								
14								
15								
16								
17								

Notes:

- a)
- b)
- c)
- d)

REV. #	BY	DATE	DESCRIPTION

Ex. UPRR Track

Prop. UPRR Track

Remove UPRR Track

Shift UPRR Track

Ex. Ind. Track

Prop. Ind. Track

Remove Ind. Track

Shift Ind. Track

Future Ind. Track

Prop. Leased Ind. Trk

Ex. Leased Ind. Trk

No RR Operations

Other Ind. Track

Right of Way

Hand Throw Turnout

Power Turnout

Power Derail

Hand Throw Derail

Point of Curve

Bridge

Signal

INSERT DESIGN FIRM
LOGO/NAME/INFO HERE



FES #: 12345	DOCUMENT TYPE: Development Concept
DRAWN BY:	UNION PACIFIC RAILROAD For use in Agreement with: Industry Name on Agreement
CHECKED BY:	LOCATION & DESCRIPTION: Railroad Station, County, State - Subdivision MP 8.09
DATE: 7/10/2025	
SHEET NUMBER 002 of 009	SHEET TITLE: Exemption Table

c:\pwwordir\benesch\projects\projects\mdispr\dms49014\UPRR.tb1
c:\pwwordir\benesch\projects\projects\mdispr\dms49015\UPRR_V8_Pentable.tb1
c:\pwwordir\benesch\projects\projects\mdispr\dms49016\UPRR_V8_Pentable.tb1
Default
7/10/2025

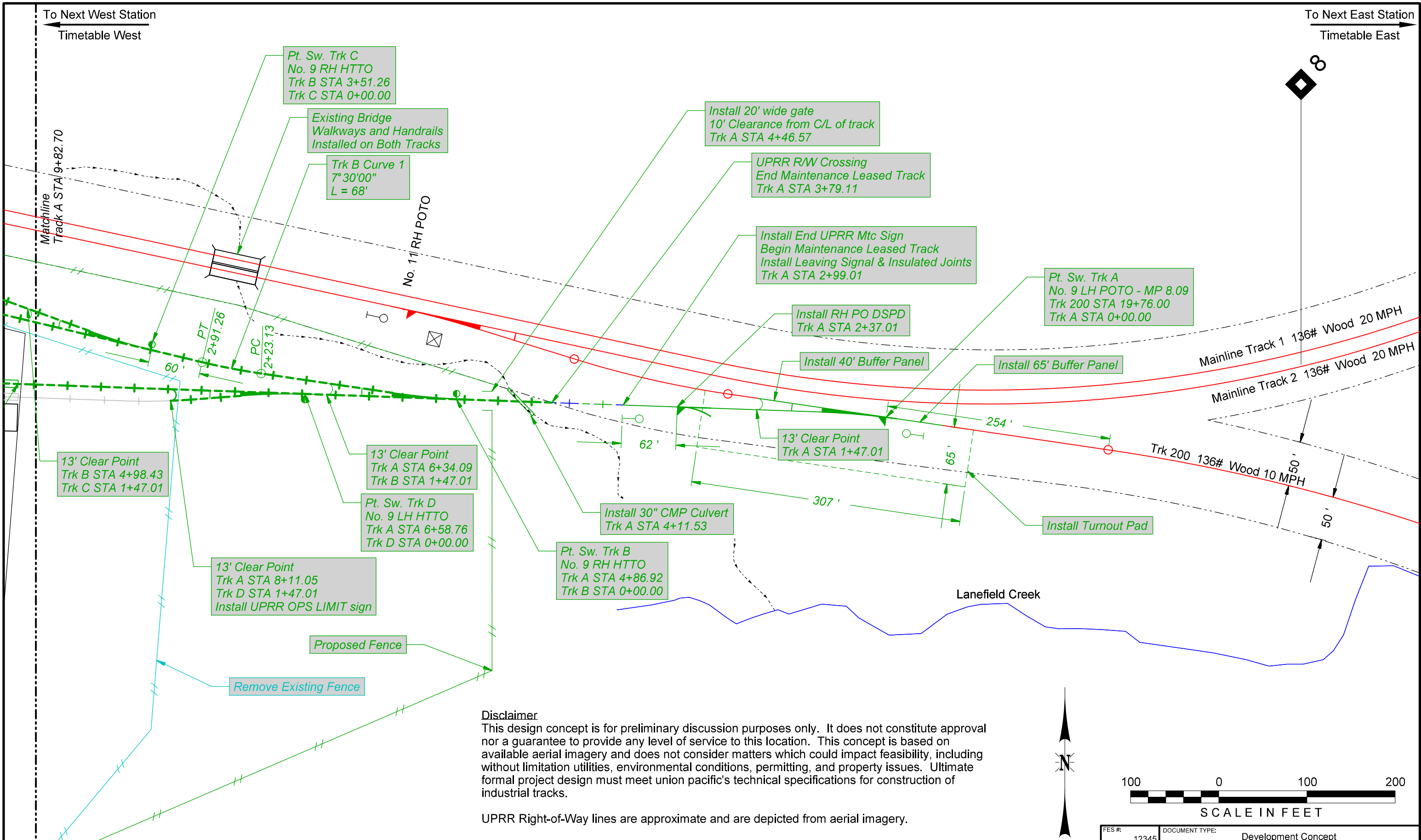

REV. #	BY	DATE	DESCRIPTION

	Ex. UPRR Track		Shift Ind. Track
	Prop. UPRR Track		Future Ind. Track
	Remove UPRR Track		Prop. Leased Ind. Trk
	Shift UPRR Track		Ex. Leased Ind. Trk
	Ex. Ind. Track		No RR Operations
	Prop. Ind. Track		Other Ind. Track
	Remove Ind. Track		Right of Way

	Hand Throw Turnout
	Power Turnout
	Power Derail
	Hand Throw Derail
	Point of Curve
	Bridge
	Signal

INSERT DESIGN FIRM
LOGO/NAME/INFO HERE



FES #:	12345	DOCUMENT TYPE:	Development Concept
DRAWN BY:		UNION PACIFIC RAILROAD	For use in Agreement with: Industry Name on Agreement
CHECKED BY:		LOCATION & DESCRIPTION:	Railroad Station, County, State - Subdivision MP 8.09
DATE:	7/10/2025	SHEET TITLE:	Plan View
SHEET NUMBER:	003 of 004		

c:\pwwordir\benesch\projects\projects\mdisper\dms49014\UPRR.tb1
c:\pwwordir\benesch\projects\projects\mdisper\dms49015\UPRR_V8_Pentable.tb1
c:\pwwordir\benesch\projects\projects\mdisper\d024169\DevCon Sample.dgn
7/10/2025

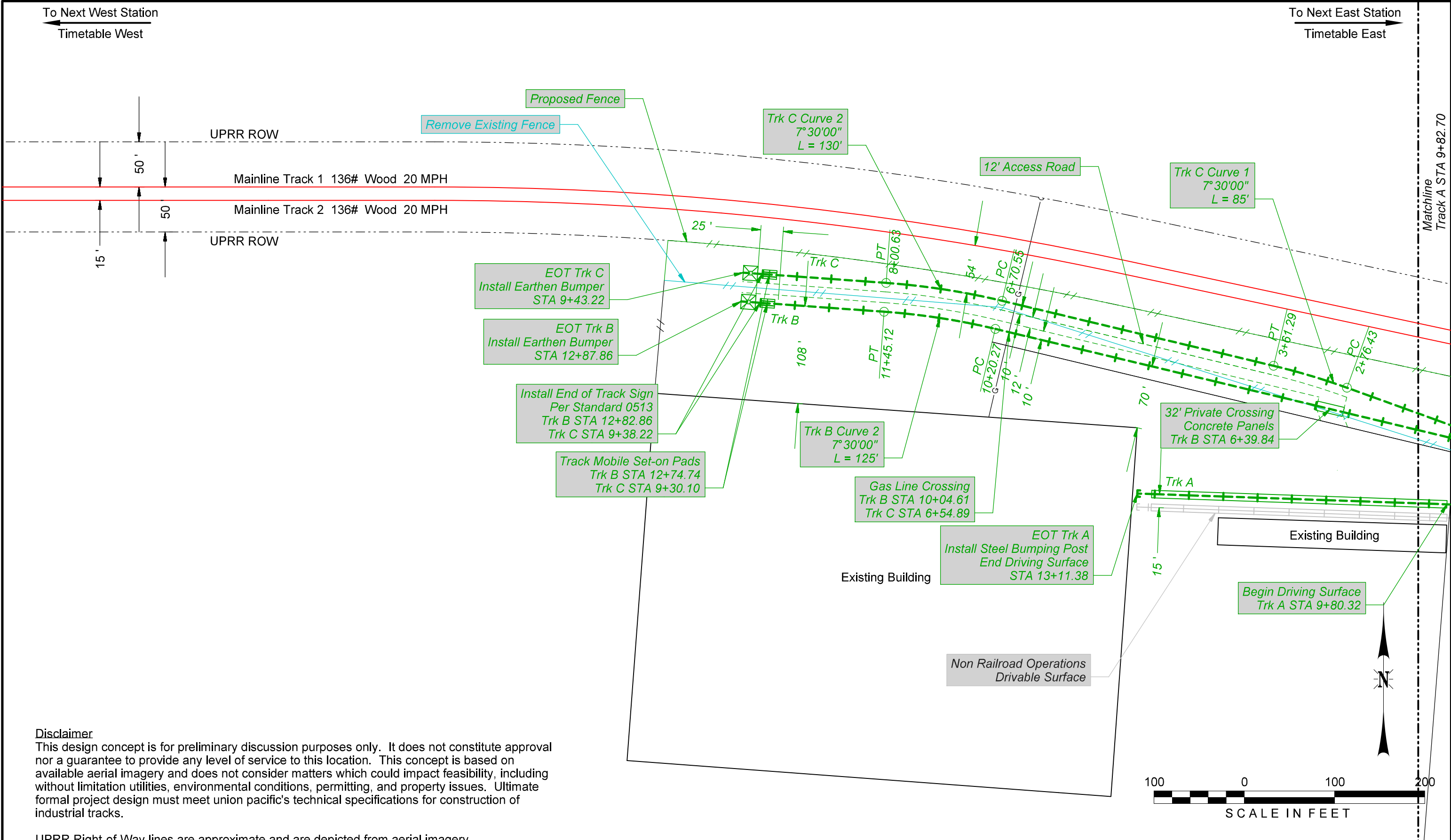

Disclaimer
This design concept is for preliminary discussion purposes only. It does not constitute approval nor a guarantee to provide any level of service to this location. This concept is based on available aerial imagery and does not consider matters which could impact feasibility, including without limitation utilities, environmental conditions, permitting, and property issues. Ultimate formal project design must meet union pacific's technical specifications for construction of industrial tracks.

UPRR Right-of-Way lines are approximate and are depicted from aerial imagery.

REV.#	BY	DATE	DESCRIPTION

	Ex. UPRR Track		Shift Ind. Track		Hand Throw Turnout
	Prop. UPRR Track		Future Ind. Track		Power Turnout
	Remove UPRR Track		Prop. Leased Ind. Trk		Power Derail
	Shift UPRR Track		Ex. Leased Ind. Trk		Hand Throw Derail
	Ex. Ind. Track		No RR Operations		Point of Curve
	Prop. Ind. Track		Other Ind. Track		Bridge
	Remove Ind. Track		Right of Way		Signal

INSERT DESIGN FIRM
LOGO/NAME/INFO HERE



FES #:	12345	DOCUMENT TYPE:	Development Concept
DRAWN BY:		UNION PACIFIC RAILROAD	For use in Agreement with: Industry Name on Agreement
CHECKED BY:		LOCATION & DESCRIPTION:	Railroad Station, County, State - Subdivision MP 8.09
DATE:	7/10/2025	SHEET TITLE:	Plan View
SHEET NUMBER:	004 of 004		