

PLACE ARROW INDICATING NORTH DIRECTION RELATIVE TO CROSSING

OVERHEAD WIRELINE CROSSING

750 VOLTS OR LESS

NOTE: ALL AVAILABLE DIMENSIONS MUST BE FILLED IN TO PROCESS THIS APPLICATION.

FORM DR-0404-D
REV 10-26-2007

www.uprr.com

NO SCALE

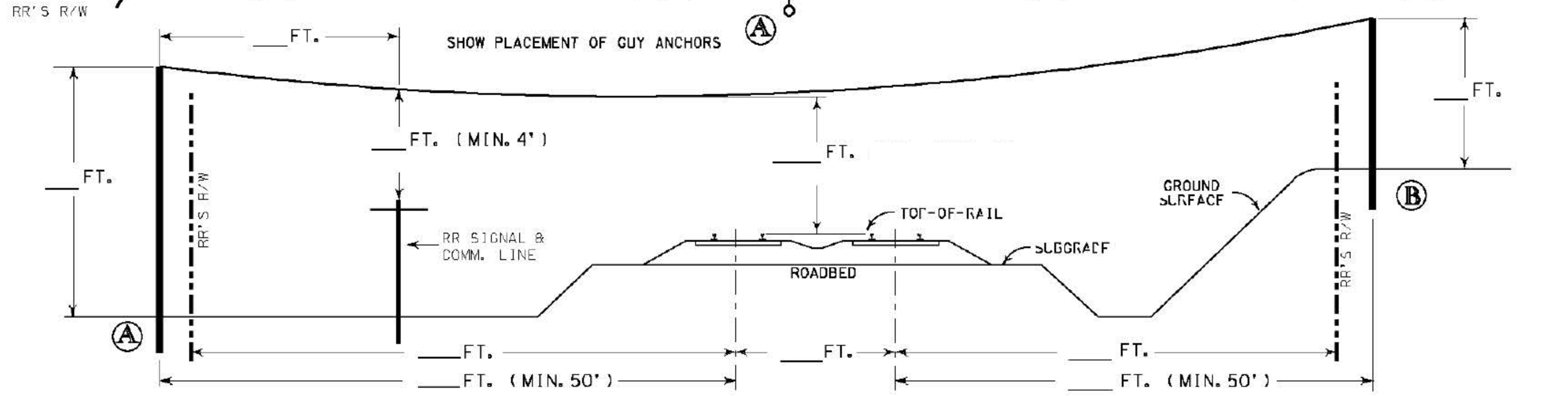
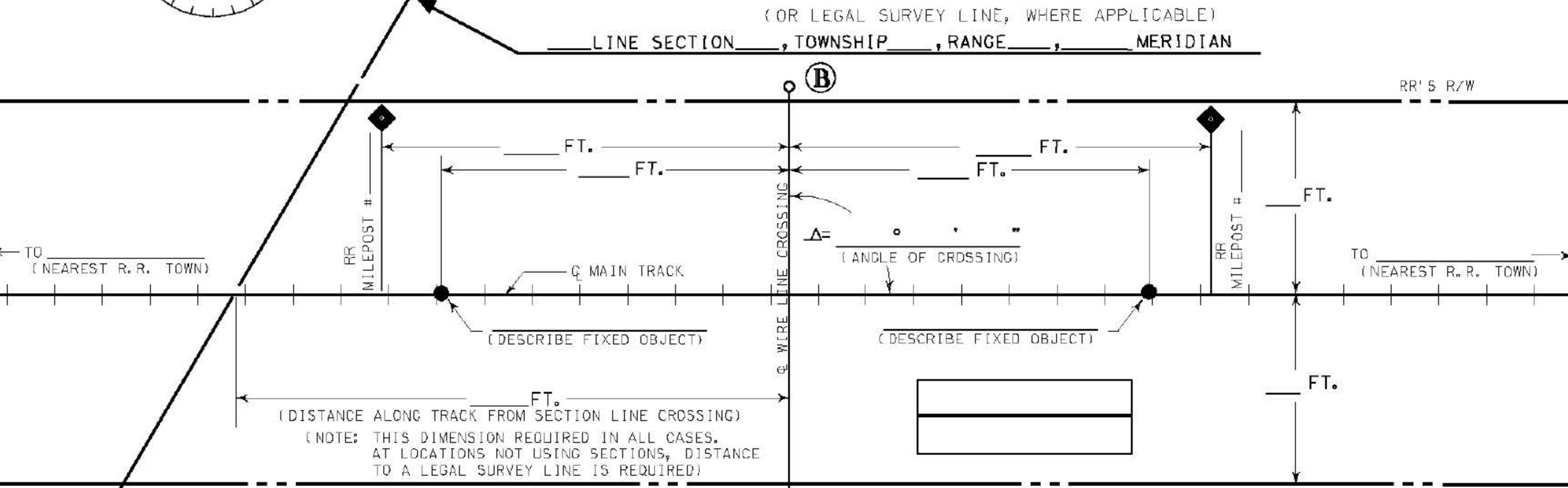
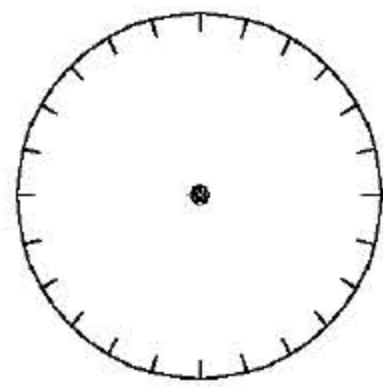

NOTES :
SEE WIRELINE INSTALLATION ENGINEERING SPECIFICATIONS

- A) TYPE WIRELINE CROSSING: _____
- B) VOLTAGE TO BE CARRIED _____ NO. OF WIRES _____
- C) CURRENT TO BE CARRIED _____
- D) WIRELINE WILL PASS _____ UPRR COMMUNICATION OR SIGNAL LINE?
WHAT IS THE MINIMUM CLEARANCE BETWEEN WIRES? _____ FEET.
- E) WILL ANY ATTACHMENTS BE MADE TO ANY EXISTING POLES? _____
- F) WILL ANY ATTACHMENTS BE MADE TO RAILROAD'S POLES? _____
- G) WHAT TYPE OF FACILITY WILL LINE BE SERVING? _____
- H) APPLICANT HAS CONTACTED 1-800-336-9193,
U. P. COMMUNICATION DEPARTMENT, AND HAS DETERMINED FIBER
OPTIC CABLE _____ EXIST IN VICINITY OF WORK TO BE PERFORMED.
TICKET NO. _____

EXHIBIT "A"

(FOR RAILROAD USE ONLY - DO NOT WRITE IN THIS BOX)

UNION PACIFIC RAILROAD CO.

(SUBDIVISION)

M. P. _____ E. S. _____

OVERHEAD WIRELINE CROSSING

(NEAREST RR STATION) (COUNTY) (STATE)

FOR _____ (APPLICANT)

RR FILE NO. _____ DATE _____

WARNING

IN ALL OCCASIONS, U. P. COMMUNICATIONS DEPARTMENT MUST BE CONTACTED IN ADVANCE OF ANY WORK TO DETERMINE EXISTENCE AND LOCATION OF FIBER OPTIC CABLE.
PHONE : 1-800-336-9193