

ASPHALT SECTION

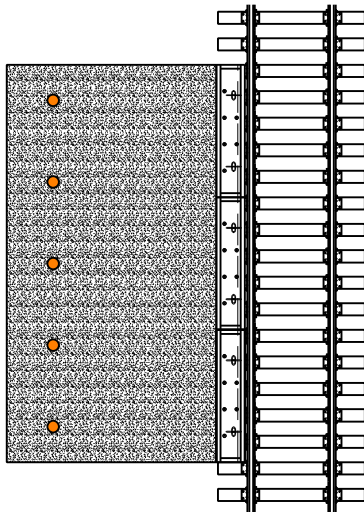

**SINGLE MAINLINE SINGLE
SIDE LANDING PAD**

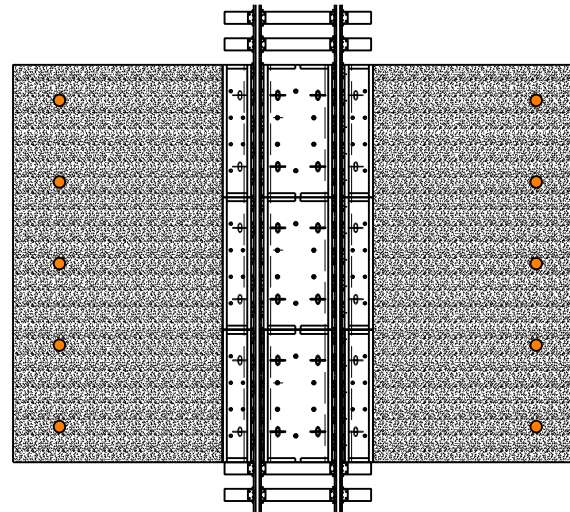

**SINGLE MAINLINE DOUBLE
SIDED LANDING PAD**

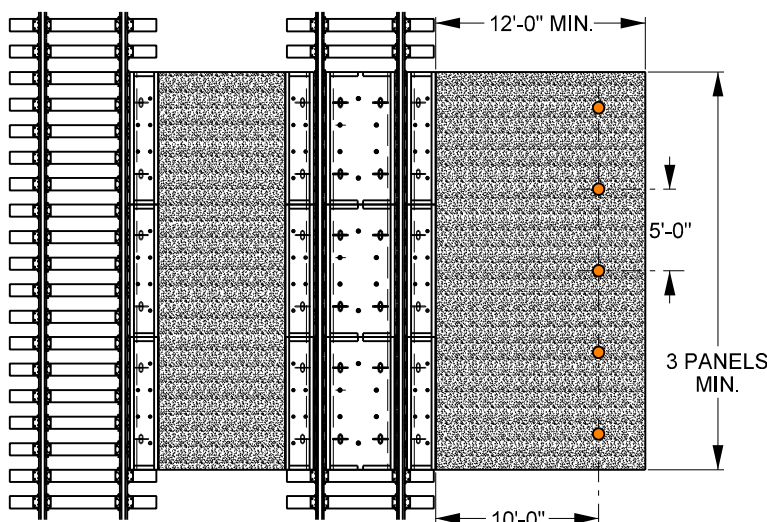

MULTIPLE MAINLINE SINGLE SIDED LANDING PAD

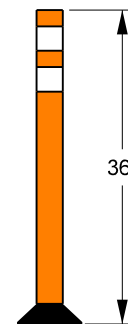

TRAFFIC DELINEATOR

DESCRIPTION	ITEM NO.
ORANGE PLASTIC DELINEATOR	390-3891
PIN LOCK BASE (1 PER DELINEATOR)	390-3895
EPOXY FASTENING KIT	390-3893

NOTES:

1. LANDING PADS TO BE UTILIZED AT POINTS WHERE CREW CHANGES WILL OCCUR. LOCATIONS WILL BE DESIGNATED BY THE SERVICE UNIT GENERAL MANAGER OR CHIEF ENGINEER.
2. LANDING PADS TO BE A MINIMUM OF THREE CONCRETE CROSSING PANELS IN LENGTH. ADDITIONAL PANELS MAY BE UTILIZED WHEN AUTHORIZED BY GENERAL MANAGER AND/OR CHIEF ENGINEER.
3. CURRENT TRACK TIES MAY BE UTILIZED FOR LANDING PAD.
4. APPROPRIATE SIZE PANELS FOR THE SIZE OF RAIL SHALL BE USED. SEE STANDARD DRAWING 0304 FOR ADDITIONAL DETAILS.
5. ASPHALT TO BE UTILIZED IN THE SECTIONS SHOWN ON THE DRAWING. ASPHALT TO BE SLOPED AWAY FROM TRACK AT AN ANGLE THAT ALLOWS FOR EASY WALKING ACCESS (CLOSER TO LEVEL IS PREFERRED). ASPHALT SHOULD EXTEND A MINIMUM OF 12' FROM THE OUTSIDE EDGE OF THE FIELD SIDE PANEL. IF ACCESS IS NEEDED TO MULTIPLE TRACKS, ASPHALT FILL SHALL BE UTILIZED BETWEEN THE TWO TRACKS AT AS LEVEL OF A SLOPE AS POSSIBLE.
6. IN LOCATIONS WHERE FOOT ACCESS IS NEEDED ON BOTH SIDES OF THE TRACK, CONCRETE PLANKS AND ASPHALT WALKWAY CAN BE EXTENDED TO THAT SIDE.
7. PLASTIC DELINEATORS TO BE USED TO PREVENT VEHICLE ACCESS TO THE LANDING PAD. DELINEATORS SHALL BE PLACED AT 5' INCREMENTS ALONG THE LANDING PAD AT A MINIMUM OF 10' FROM THE OUTSIDE EDGE OF THE FIELD SIDE CONCRETE PANEL. DELINEATORS ARE TO BE 36" HIGH AND ANCHORED TO THE ASPHALT USING EPOXY OR LAGS. ONE EPOXY KIT IS REQUIRED PER DELINEATOR AND MUST BE MIXED ACCORDING TO THE INSTRUCTIONS PROVIDED.
8. FOR INDUSTRY LANDING PADS, CREATE A 12' WIDE BY 24' LONG (PARALLEL TO TRACK) PAD AT THE TOP OF TIE ELEVATION USING WALKWAY BALLAST. EXTEND THE 2% SUBGRADE TO ACCOMMODATE THIS WALKWAY BALLAST PAD AT 3:1 SLOPE.

**UNION PACIFIC RAILROAD
ENGINEERING STANDARDS**

LANDING PAD



APPROVED: *Eric Selinger*
VP ENGINEERING
ADOPTED: SEP. 23, 2010
REVISED: DEC. 9, 2019
FILE NO.: 0309C

STD DWG
0309C